

Repair Parts Sheet	Revision	Revision Date	Product Code Beginning
L3018	Rev. H	10/22	B, C4420K, C0421K, &C4818K

Fig. 1, Cylinder Assembly

- ▲ = Standard Repair Kit RC25K51.
- = Spring Kit (varies by cylinder model - see page 2).
- ◆ = Premium Repair Kit RC25K71.
- * = See Notes section for additional information.

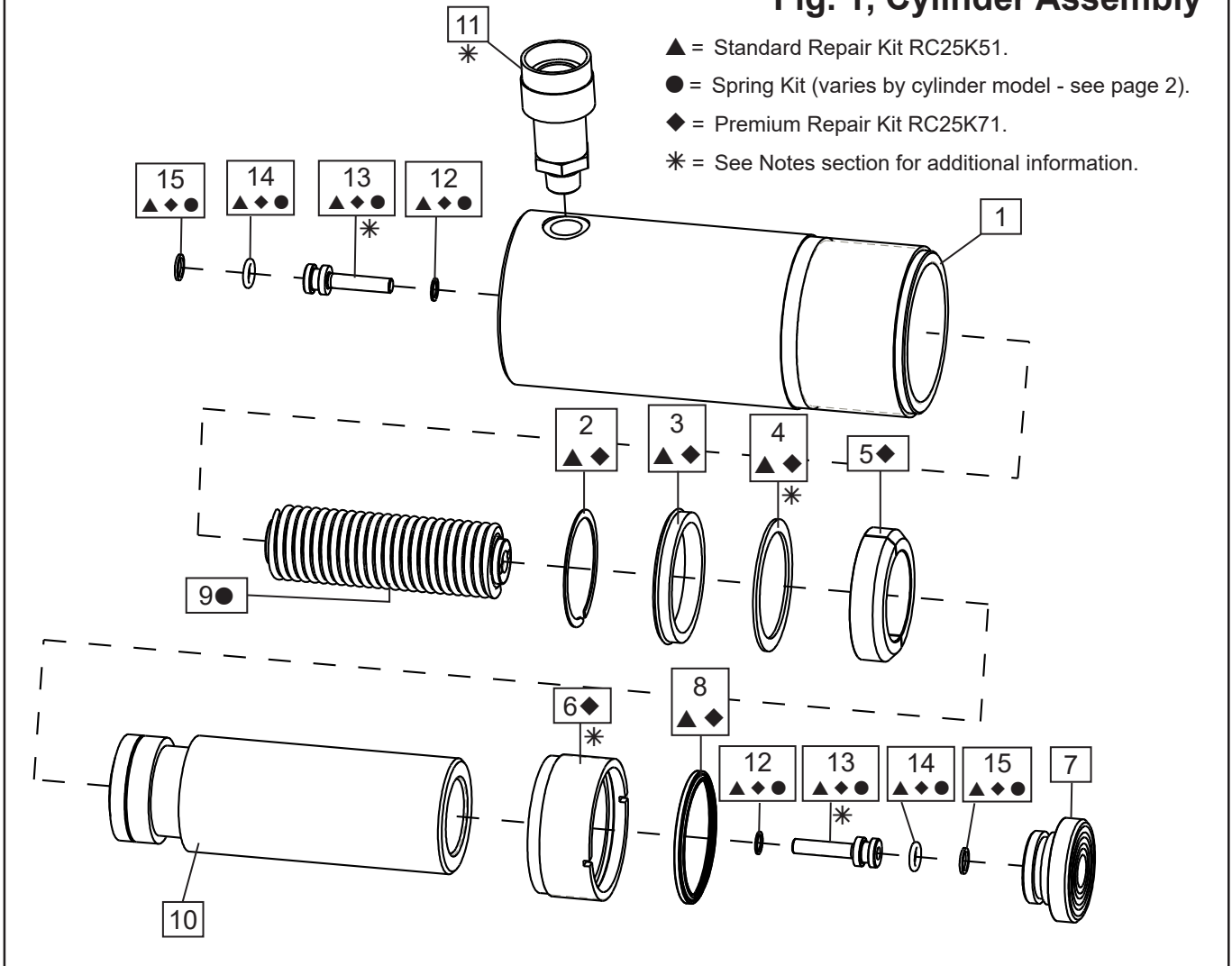

**Note: See Page 2
for parts list.**

(*) Notes	
Item	Torque / notes
4	Washer to be placed with the sharp edge towards U-Cup.
6	7.9 - 10.2 Nm, 70 - 90 In - Lbs
6	Secure with Loctite 222.
11	54 - 81 Nm, 40- 60 Ft - Lbs
11	Use Loctite 545 or Teflon tape.
13	10.2 - 12.4 Nm, 90 - 110 In - Lbs

Repair Parts List, Figure 1

L3018

Item	Description	Qty.	Part Number		
			RC-251	RC-252	RC-254
1	Base	1	(Not Available)	(Not Available)	(Not Available)
2	Retaining Ring ▲◆	1	G908044	G908044	G908044
3	U-Cup ▲◆	1	DD2390041	DD2390041	DD2390041
4	Washer ▲◆	1	G907108	G907108	G907108
5	Rod Bearing ◆	1	G898107	G898107	G898107
6	Stop Ring ◆	1	G899044	G899044	G899044
7	Saddle, Grooved	1	A252G	A252G	A252G
8	Wiper Ring ▲◆	1	G731044	G731044	G731044
9	Spring ●	1	DD2289110	DD2351110	DD2353110
10	Plunger	1	(Not Available)	(Not Available)	(Not Available)
11	Coupler	1	CR-400	CR-400	CR-400
12	Gasket ▲◆●	2	C846037	C846037	C846037
13	Spring Retainer ▲◆●	2	DD2065160	DD2065160	DD2065160
14	O-Ring ▲◆●	2	B1110903	B1110903	B1110903
15	Ring, Back-up ▲◆●	2	B1110564	B1110564	B1110564
N/S	Dust Cap ▲◆	1	DD1782020	DD1782020	DD1782020
N/S	Thread Protector ▲◆	1	DD1776271	DD1776271	DD1776271
N/S	O-Ring Coupler ▲◆	1	B1116803	B1116803	B1116803
N/S	Enerpac Decal ▲◆	1	DD2215026	DD2215026	DD2215026
N/S	Warning Decal ▲◆	1	CH272026	CH272026	DA5625026
N/S	O-Ring Saddle ▲◆	1	B1021503	B1021503	B1021503
▲	Repair Kit, Standard	-	RC25K51	RC25K51	RC25K51
◆	Repair Kit, Premium	-	RC25K71	RC25K71	RC25K71
●	Spring Kit	-	RC25K31	RC25K32	RC25K33

Notes:

Premium repair kit includes all standard (▲) repair kit items plus additional premium (◆) items.

N/S = Item not shown.

IMPORTANT: Shaded items are available only in kits (not sold separately).

Cylinders with Viton components only: Order Repair Kit RC2510KV in addition to Repair Kit RC25K51 or RC25K71.
 Repair Kit RC2510KV includes Viton components for items 3 and 8. Standard components are used in other locations.



www.enerpac.com