

**Contents:**

Figure 1 - Pump Side View .....	2	Figure 9 - Shroud Wiring-Left of Motor .....	5
Figure 2 - Pump Front View (shroud removed).....	2	Figure 10 - Shroud Wiring-Right of Motor.....	5
Figure 3 - Valve and Manifold Assembly .....	2	Figure 11 - Top View, Cord and Cables.....	6
Figure 4 - Pump Bottom View .....	2	Figure 12 - Remote Pendant Assembly .....	7
Figure 5 - Pump Front View (assembled) .....	3	Figure 13 - Electrical Schematic, PUM Models.....	8
Figure 6 - Pump Top View .....	4	Figure 14 - Electrical Schematic, PUJ Models (115V).....	8
Figure 7 - Shroud Wiring-Behind Motor .....	5	Figure 15 - Electrical Schematic, PUJ Models (220V).....	9
Figure 8 - Shroud Wiring-Front of Motor.....	5		

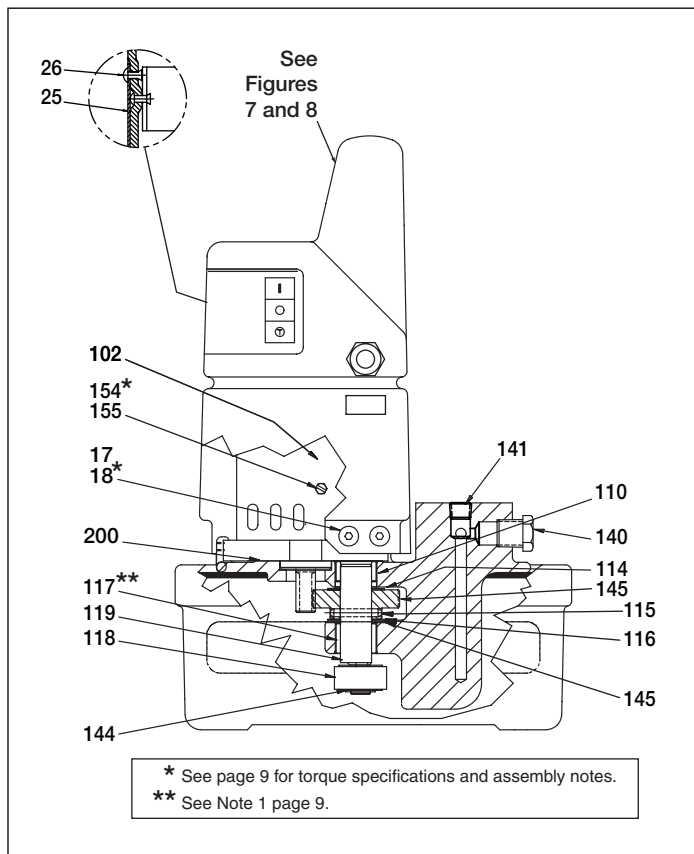

**Figure 1, Pump Side View**

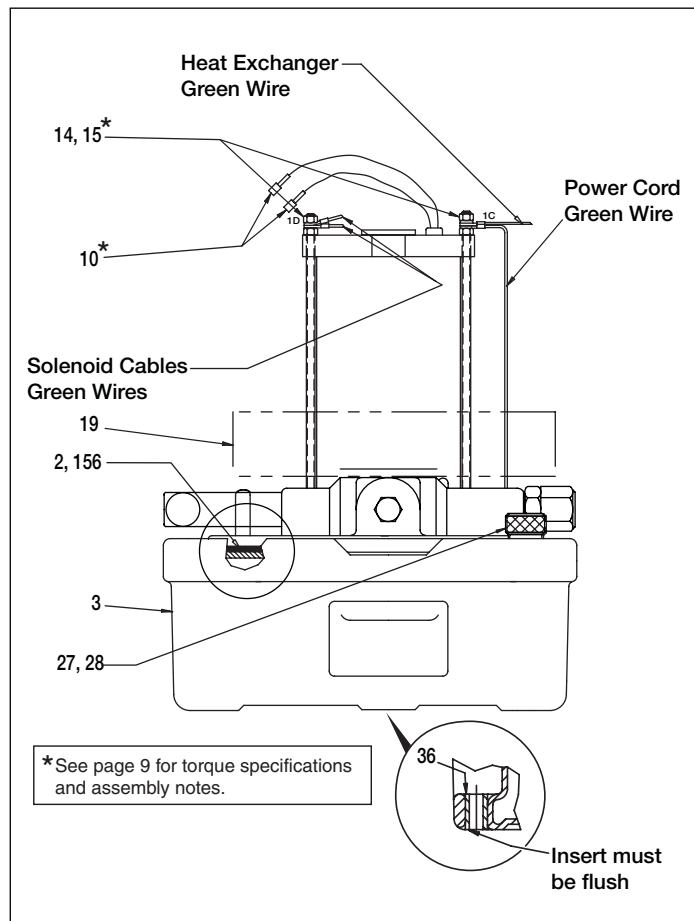

**Figure 2, Pump Front View (shroud removed)**

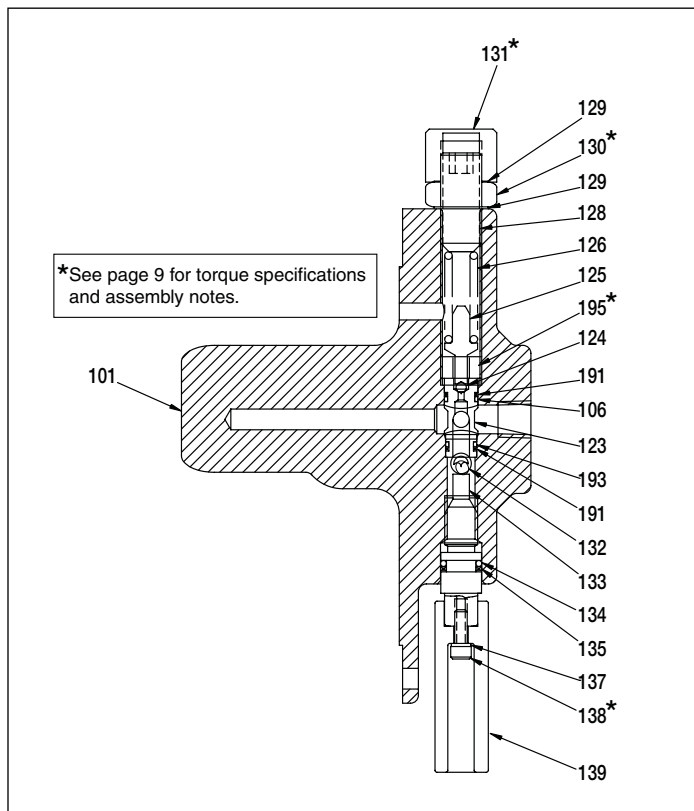

**Figure 3, Valve and Manifold Assembly**

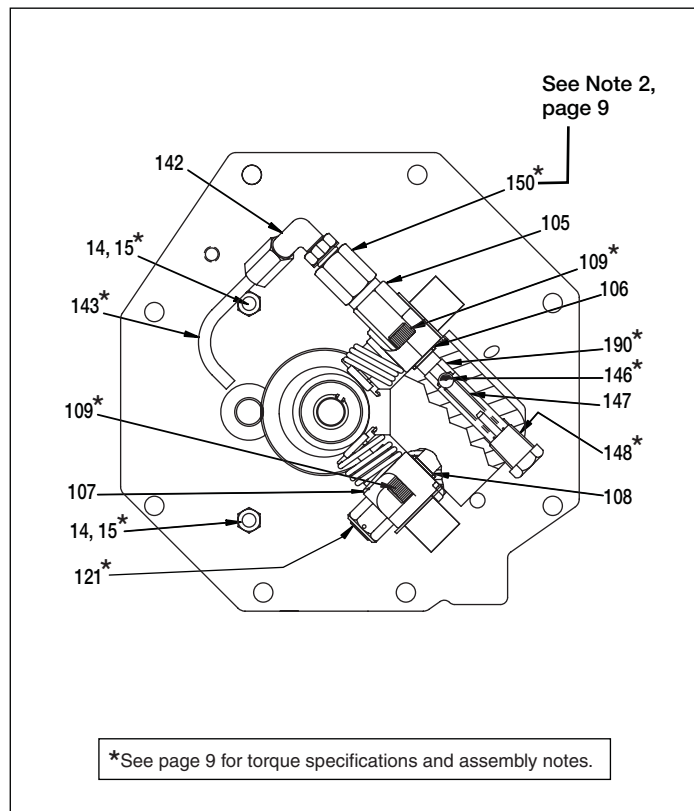

**Figure 4, Pump Bottom View**

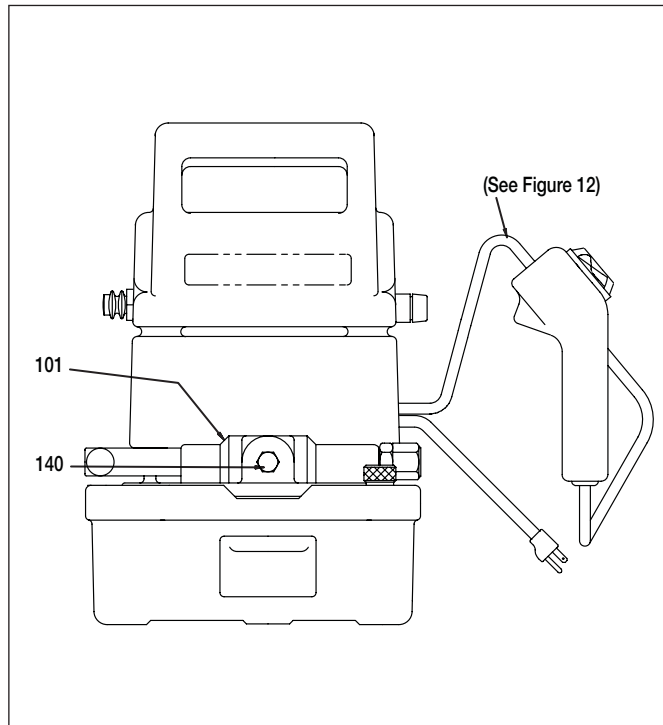

Figure 5, Pump Front View (assembled)

**Repair Parts List for Figures 1 through 5**

Item	Part Number	Qty.	Description
2	★ DA12088167SR	1	Gasket (Includes item 156)
3	DA1910900SR	1	Reservoir Assembly. 0.5 Gal.
	DA4780900SR	1	Reservoir Assembly. 1.0 Gal.
10	DA3776006	2	Pin
14	DA15066	3	Lock Washer
15	B1018121	3	Hex Nut
17	CW261225	6	Eyelet
18	F866028	6	Machine Screw
19	CW259298	1	Baffle
25	Contact Enerpac	1	Nameplate
26	DC818003	4	Pop Rivet
27	DA608024	1	Vent Plug
28	★ B1906503	1	O-Ring
36	DA931225	2	Insert
101	DA12486840SR	1	Pump Manifold (includes # 121)
102	CW179259	1	115 VAC Motor
	DC1415259	1	220 VAC Motor (50 Hz)
105	CW298950SR	1	.53 Piston Block Assembly
106	★ B1007503	1	O-Ring
107	CW299950SR	1	.24 Piston Block Assembly
108	★ B1012803	1	O-Ring
109	B1010028X	4	Screw
110	CW252107	1	Bearing
114	CW301228	1	Driven Gear
115	★ B1097057	1	Spring Pin
116	★ CW199107	1	Bearing
117	CW251107	1	Bearing
118	CW302107	1	Bearing
119	CW303104	1	Shaft
121	DA5999900SR	1	Relief Valve (see Figure 4)
123	★ DA12199290	1	Ball Seat Insert
124	★ B1004016	1	Ball (0.156 in. dia.)
125	DC990900	1	Ball Guide

★ Included in Repair Kit PUJ1200BK1

Item	Part Number	Qty.	Description
126	★ A109164	1	Compression Spring
128	DA252028	1	Adjusting Screw
129	★ S1167	1	Gasket
130	CW306055	1	Lock Nut
131	CW307055	1	Cap Nut
132	★ B1009016	1	Ball (0.312 in. dia.)
133	C790010SR	1	Stem
134	★ B1111203	1	O-Ring, Viton
135	★ B1111564	1	Washer
137	B1086066	1	Lockwasher
138	B1323028	1	Screw, Socket Head
139	DA544070SR	1	Handle
140	R515245-2	1	Plug
141	A1016245	1	Plug
142	DA1011096	1	Elbow
143	DA261268	1	Tube
144	★ CW467044	1	Retaining Ring
145	★ DA445107	2	Bearing
146	★ B1007016	1	Ball
147	★ DA1564110	1	Spring
148	DC433950	1	Plug Assembly
150	DA610900SR	1	Relief Valve Assembly
154	★ CU876028	3	Screw (10-24)
155	DA3585186	3	Spacer
156	See item 2	1	Gasket
190	DA12352290	1	Ball Seat
191	★ B1012565	2	Washer, Back-up
193	★ DC19503	1	O-Ring
195	DC866027	1	Lock Screw
200	★ DC1947167	1	Gasket

**Replacement Brushes for Electric Motor**

- - -	DA9655380	1	Brush Set for 115V Models
- - -	DA9656380	1	Brush Set for 220V Models

\* See page 9 for torque specifications and assembly notes.

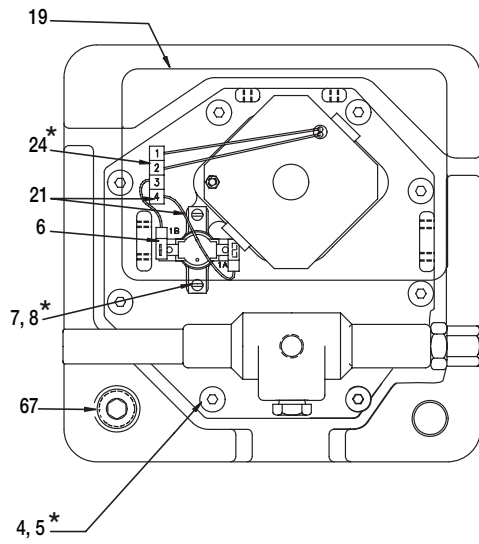
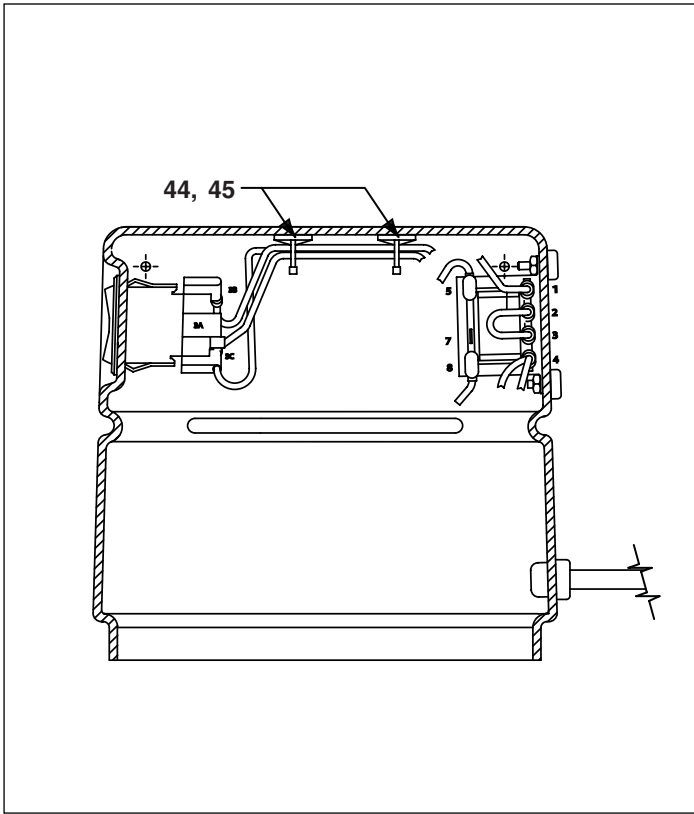

Figure 6, Pump Top View

**Repair Parts List for Figure 6**

Item	Part Number	Qty.	Description
4	DA6954167	8	Gasket
5	DC2038028	8	Screw
6	E1100004	1	Thermostat, 115V
	DC8401372	1	Thermostat, 220V
7	C701222	2	Washer
8	M642028	2	Screw
19	CW259298	1	Baffle
21	DC7969960	2	Wire Assembly
24	DA11540380	1	Pin Housing
67	A1009245	2	Plug



**Figure 7, Shroud Wiring - Behind Motor**

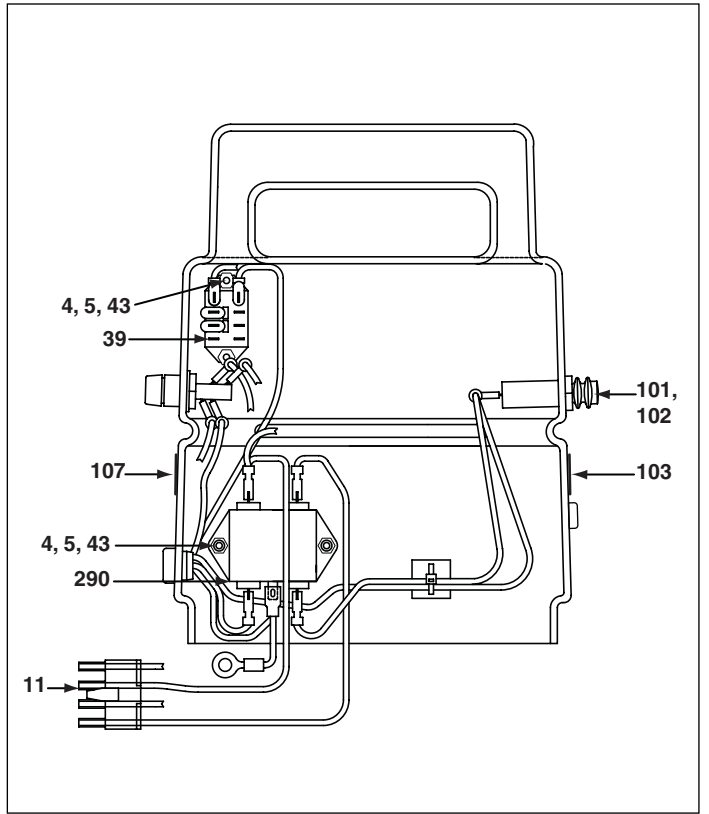

**Figure 8, Shroud Wiring - Front of Motor**

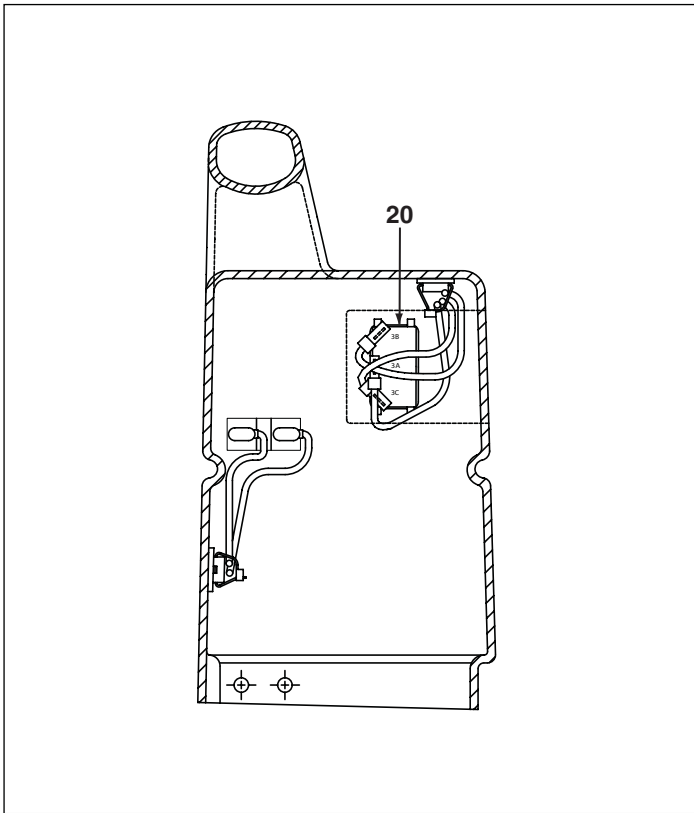

**Figure 9, Shroud Wiring - Left of Motor**

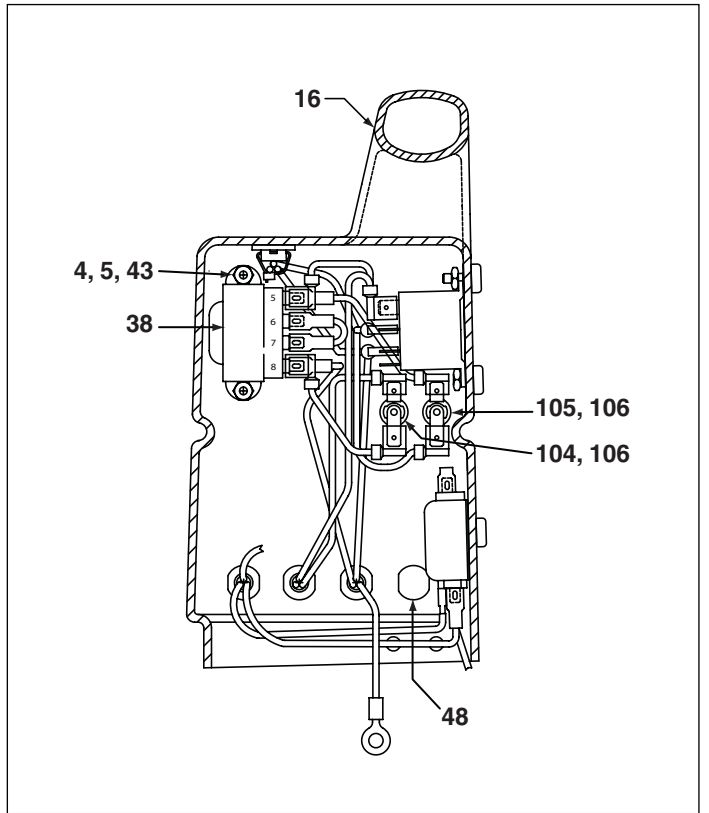

**Figure 10, Shroud Wiring - Right of Motor**

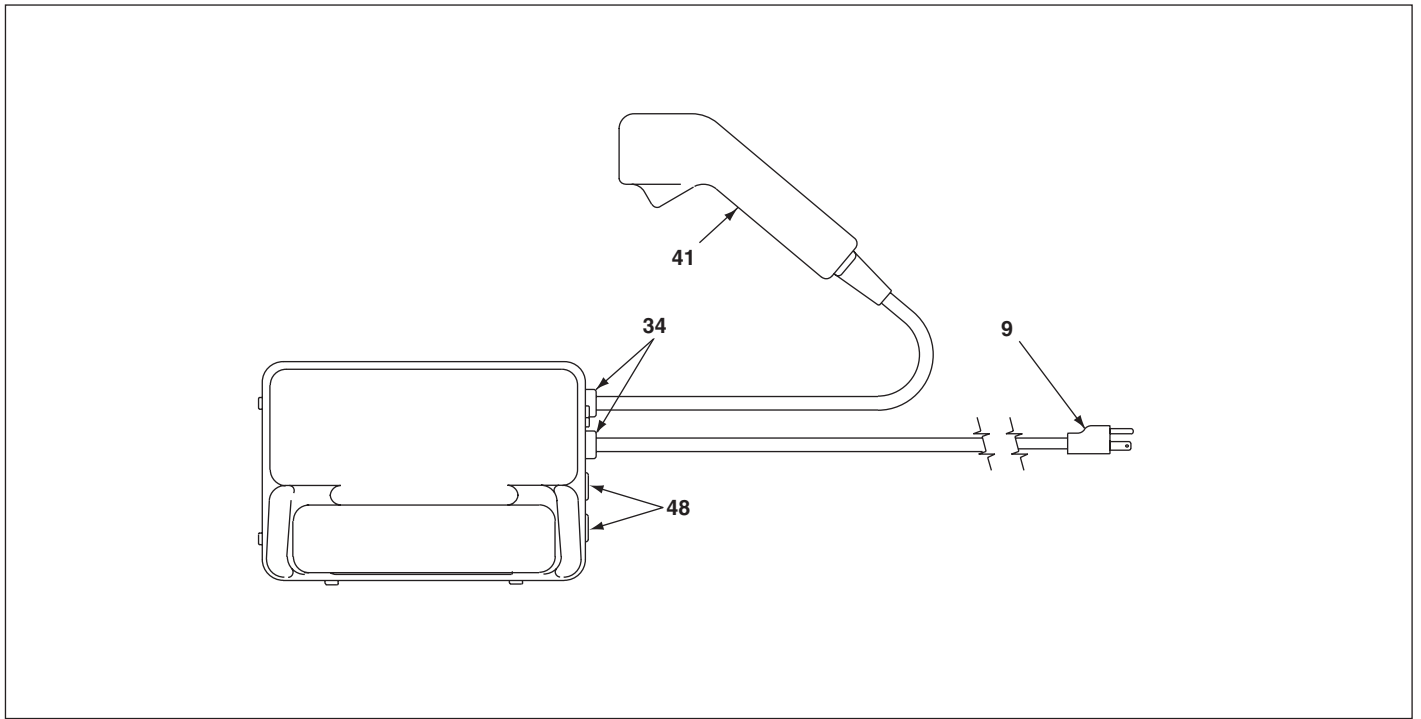
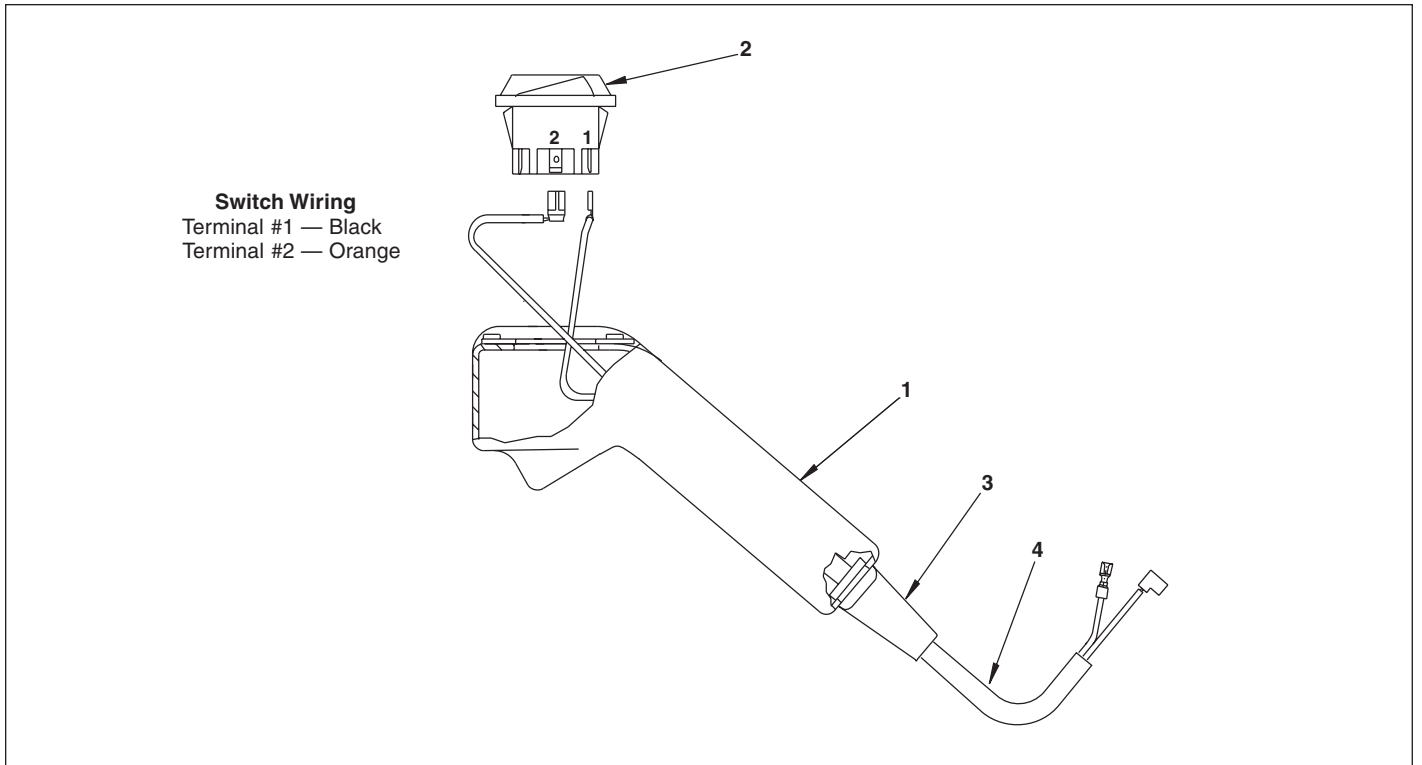

Figure 11, Top View, Cord and Cables

Repair Parts List for Figures 7 through 11

Item	Part Number	Qty.	Description	Item	Part Number	Qty.	Description
4	BC1310728	4	Screw (115V)	43	DA5974098	4	Screw Cover (115V)
	BC1310728	6	Screw (220V)		DA5974098	6	Screw Cover (220V)
5	F75021	4	Lock Nut #6-32 (115V)	44	EHC3901075	3	Tie Down, Self Adhesive
	F75021	6	Lock Nut #6-32 (220V)	45	DA3131217	4	Cable Tie
9	DC7954960SR	1	Power Cord (115V)	48	DA3731009	2	Hole Plug
	DC10008960SR	1	Power Cord (220V)	101	DC8366380	1	Circuit Breaker (115V)
11	DA11539380	1	Receptacle		DC8367380	1	Circuit Breaker (220V)
16	DC10035098	1	Shroud - PUM Models	102	DC8200380	1	Circuit Breaker Reset Cap
	DC10037098	1	Shroud - PUJ Models (115V)	103	DC8237023	1	Circuit Breaker Decal
	DC10036098	1	Shroud - PUJ Models (220V)	104	DC8371378	1	Secondary Fuse, 300mA
20	E1500002	1	Switch	105	DC8370378	1	Primary Fuse, 62mA (115V)
34	CR759291	2	Cord Bushing		DC8400378	1	Primary Fuse, 40mA (220V)
38	DA5875380	1	Transformer	106	DC8372378	2	Fuse Holder
39	E1300008	1	Relay, D1 - PUJ Only (115V)	107	DC7891026	1	Fuse Decal
	DC8280980	1	Relay, D1 - PUJ Only (220V)	290	DC8365380	1	EMI Filter (220V only)
41	DC7953900SR	1	Pendant Assy - PUJ Only				

Note: For replacement shroud assembly:  
 • Model PUM1200B only: Order Repair Kit DC7942900SR.  
 • PUJ Models, 115V: Order Repair Kit DC7933900SR.  
 • PUJ Models, 220V: Order Repair Kit DC7934900SR.



**Figure 12, Remote Pendant Assembly**

Repair Parts List for Figure 12							
Item	Part Number	Qty.	Description	Item	Part Number	Qty.	Description
1	CU598190	1	Pendant Body	3	DA1568007	1	Strain Relief
2	CU911372	1	Switch	4	DC10003960	1	Wire Assembly
For complete replacement pendant assembly, order part number DC7953900SR.							

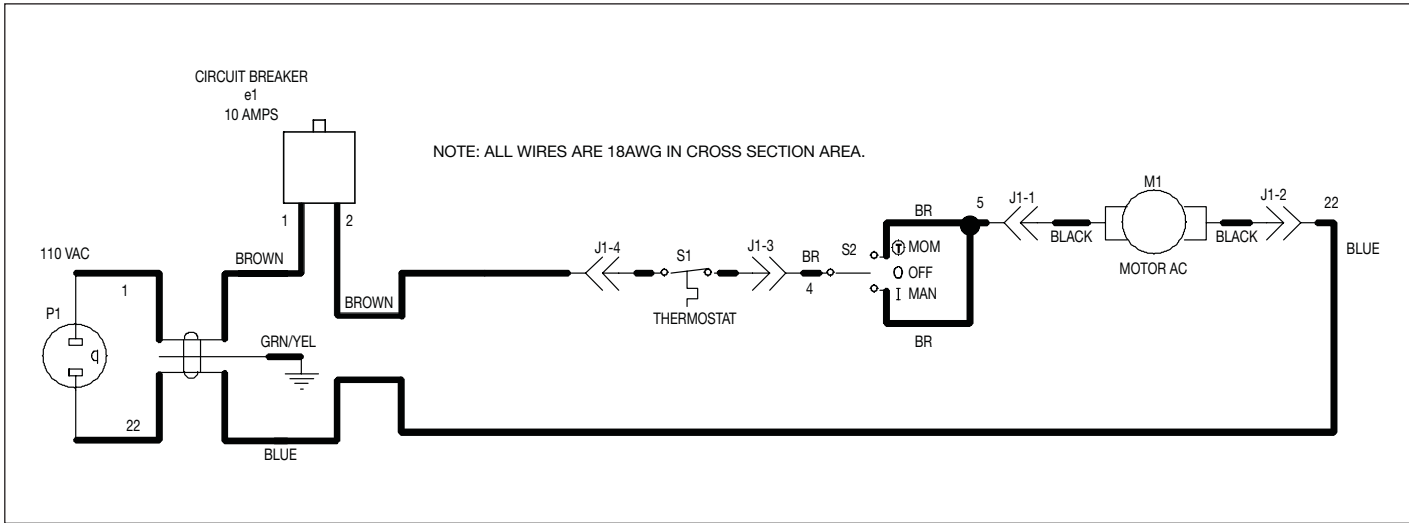

Figure 13, Electrical Schematic, PUM Models

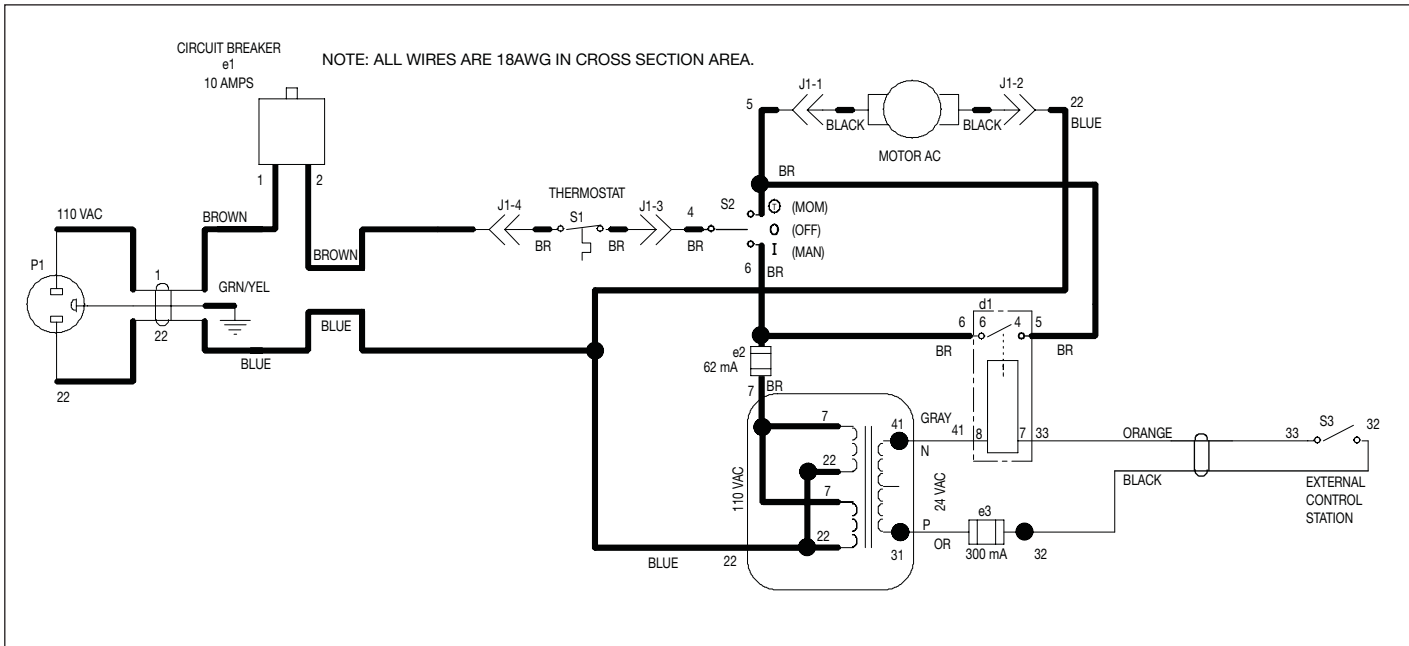
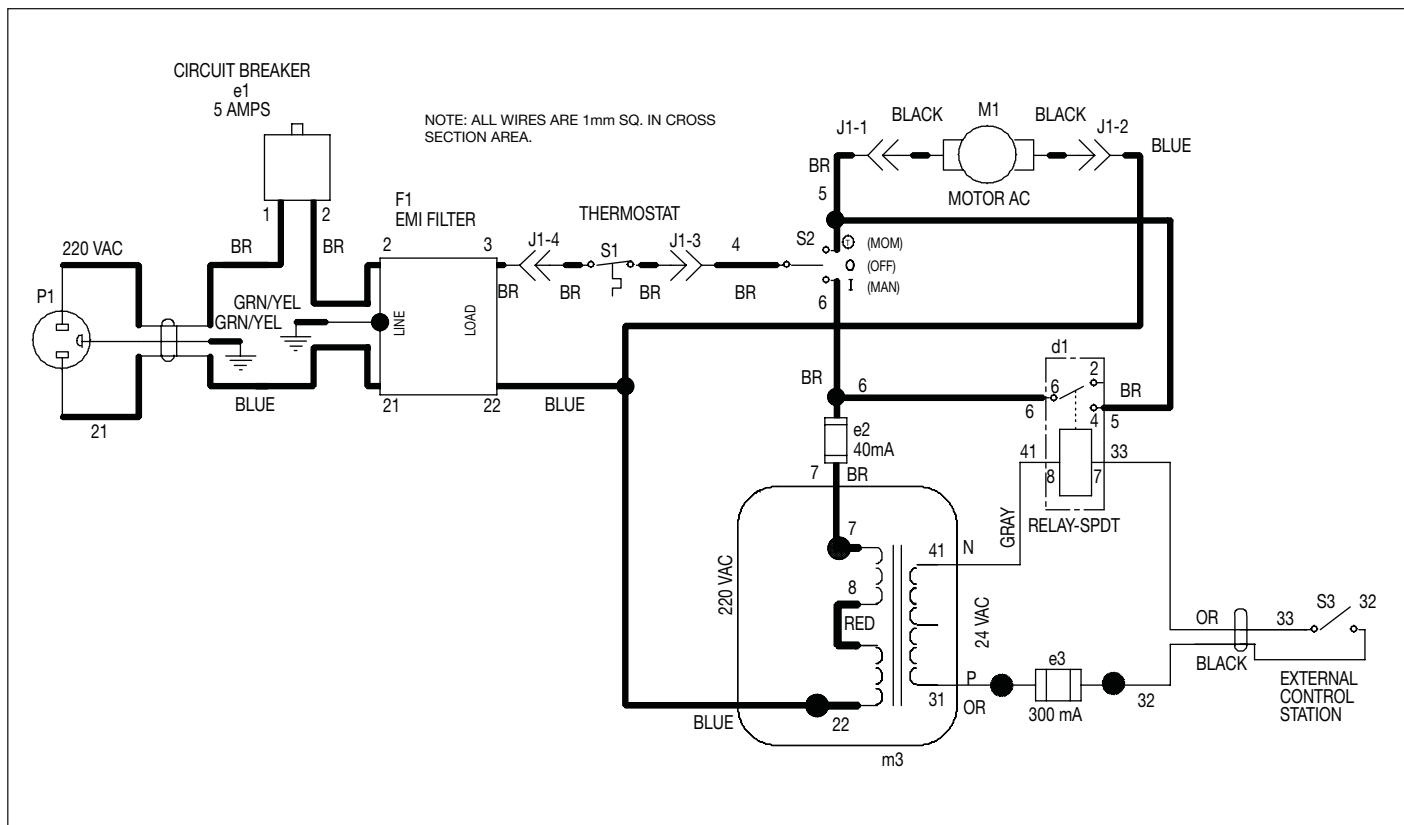

Figure 14, Electrical Schematic, PUJ Models (115V)





**Figure 15, Electrical Schematic, PUJ Models (220V)**

Figure	Item No.	Torque Specification and/or Assembly Notes
1	18	Apply 1 drop Loctite #242 to threads. Torque to 12 to 18 in-lbs (1,4 to 2,0 Nm).
1	154	Torque to 27-31 in-lbs (3,1 to 3,5 Nm).
1	Note 1	Install bearing, Item 117, flush to 0.010" (2,54 mm) recessed from surface.
2	10	Trim wire length to 9 to 10 inches (228 - 254 mm) before attaching pins (item 10). Then insert into item 24.
2	15	Torque to 27 to 31 in-lbs, (3,1 to 3,5 Nm).
3	130,131	Torque to 15 to 20 ft-lbs (20 to 27 Nm).
3	138	Torque to 25-30 in-lbs (28,8 to 34,5 cm/kg). Apply Locite 242 to threads before assembly.
3	195	Torque to 6-10 ft-lbs (8,1 to 13,5 Nm).
4	15	Torque to 27-31 in-lbs (3,1 to 3,5 Nm).
4	109	Torque to 14 to 16 ft-lbs, dry (19,0 to 21,7 Nm).
4	121	Torque to 16-19 ft-lbs, dry (21,7 to 25,8 Nm).
4	143	Align tube to face mesh and splash lubricate upper needle bearing.
4	146	Seat must be coined prior to assembly.
4	148	Assemble with Loctite #545.
4	150	Relief valve setting should be from 250 to 400 psi (17,3 to 27,9 bar).
4	190	Assemble with Loctite #609.
4	Note 2	Stake threads after setting pressure.
6	5	Torque to 47-53 in-lbs (5,3 to 6,0 Nm). Use Loctite #242 on item #5.
6	8	Torque to 9-12 in-lbs (1,0-1,3 Nm).
6	24	Attach to receptacle on shroud.

## Enerpac Worldwide Locations

### Africa

ENERPAC Middle East FZE  
Office 423, JAFZA 15  
P.O. Box 18004  
Jebel Ali, Dubai  
United Arab Emirates  
Tel: +971 (0)4 8872686  
Fax: +971 (0)4 8872687

### Australia, New Zealand

Actuant Australia Ltd.  
Block V Unit 3  
Regents Park Estate  
391 Park Road  
Regents Park NSW 2143  
(P.O. Box 261) Australia  
Tel: +61 297 438 988  
Fax: +61 297 438 648

### Brazil

Power Packer do Brasil Ltda.  
Rua dos Inocentes, 587  
04764-050 - Sao Paulo (SP)  
Tel: +55 11 5687 2211  
Fax: +55 11 5686 5583  
**Toll Free in Brazil:**  
Tel: 0800 891 5770  
vendasbrasil@enerpac.com

### Canada

Actuant Canada Corporation  
6615 Ordan Drive, Unit 14-15  
Mississauga, Ontario L5T 1X2  
Tel: +1 905 564 5749  
Fax: +1 905 564 0305  
**Toll Free:**  
Tel: +1 800 268 4987  
Fax: +1 800 461 2456  
**Technical Inquiries:**  
techservices@enerpac.com

### China

Actuant Industries Co. Ltd.  
No. 6 Nanjing Road  
Taicang Economic Dep Zone  
Jiangsu, China  
Tel: +86 0512 5328 7529  
+86 0512 5328 7500 7529  
Fax: +86 0512 5335 9690

### Actuant China Ltd. (Beijing)

709B Diyang Building  
Xin No. 2  
Dong San Huan North Rd.  
Beijing City  
100028 China  
Tel: +86 10 845 36166  
Fax: +86 10 845 36220

◆ e-mail: [info@enerpac.com](mailto:info@enerpac.com)

### Central and Eastern Europe, Greece

ENERPAC GmbH  
P.O. Box 300113  
D-40401 Düsseldorf  
Willstätterstrasse13  
D-40549 Düsseldorf  
Germany  
Tel: +49 211 471 490  
Fax: +49 211 471 49 28

### France, Switzerland francophone

ACTUANT - ENERPAC  
France S.A., ZA de Courtaboeuf  
32, avenue de la Baltique  
91140 Villebon / Yvette  
France  
Tel: +33 1 60 13 68 68  
Fax: +33 1 69 20 37 50

### Germany, Austria and Switzerland

ENERPAC GmbH  
P.O. Box 300113  
D-40401 Düsseldorf  
Willstätterstrasse13  
D-40549 Düsseldorf  
Germany  
Tel: +49 211 471 490  
Fax: +49 211 471 49 28

### India

ENERPAC Hydraulics  
(India) Pvt. Ltd.  
No. 1A,  
Peenya Industrial Area,  
IInd Phase  
Bangalore, 560 058 India  
Tel: +91 80 40 792 777  
Fax: +91 80 40 792 792

### Italy

ENERPAC S.p.A.  
Via Canova 4  
20094 Corsico (Milano)  
Tel: +39 02 4861 111  
Fax: +39 02 4860 1288

### Japan

Applied Power Japan LTD KK  
Besshochou 85-7  
Kita-ku,  
Saitama-shi 331-0821  
Japan  
Tel: +81 48 662 4911  
Fax: +81 48 662 4955

### Middle East, Turkey and Caspian Sea

ENERPAC Middle East FZE  
Office 423, JAFZA 15  
P.O. Box 18004  
Jebel Ali, Dubai  
United Arab Emirates  
Tel: +971 (0)4 8872686  
Fax: +971 (0)4 8872687

### Russia and CIS (excl. Caspian Sea Countries)

Actuant LLC  
Admiral Makarov Street 8  
125212 Moscow, Russia  
Tel: +7-495-9809091  
Fax: +7-495-9809092

### Scandinavia

ENERPAC Scandinavia AB  
Fabriksgatan 7  
41250 Gothenburg  
Sweden  
Tel: +46 31 7990281  
Fax: +46 31 7990010

### Singapore

Actuant Asia Pte. Ltd.  
37C, Benoi Road Pioneer Lot,  
Singapore 627796  
Tel: +65 68 63 0611  
Fax: +65 64 84 5669  
**Toll Free:** +1800 363 7722  
**Technical Inquiries:**  
techsupport@enerpac.com.sg

### South Korea

Actuant Korea Ltd.  
3Ba 717,  
Shihwa Industrial Complex  
Jungwang-Dong, Shihung-Shi, Kyunggi-Do  
Republic of Korea 429-450  
Tel: +82 31 434 4506  
Fax: +82 31 434 4507

### Spain and Portugal

ENERPAC SPAIN, S.L.  
Avda. Los Frailes, 40 – Nave C & D  
Pol. Ind. Los Frailes  
28814 DAGANZO DE ARRIBA (Madrid)  
Spain  
Tel: +34 91 661 11 25  
Fax: +34 91 661 47 89

◆ internet: [www.enerpac.com](http://www.enerpac.com)

### The Netherlands, Belgium, Luxembourg, Denmark, Norway, Finland and Baltic States

ENERPAC B.V.  
Galvanistraat 115, 6716 AE Ede  
P.O. Box 8097, 6710 AB Ede  
The Netherlands  
Tel: +31 318 535 911  
Fax: +31 318 525 613  
+31 318 535 848

**Technical Inquiries Europe:**  
techsupport.europe@enerpac.com

### United Kingdom, Ireland

Enerpac Ltd  
Bentley Road South  
Darlaston, West Midlands  
WS10 8LQ, United Kingdom  
Tel: +44 (0)121 50 50 787  
Fax: +44 (0)121 50 50 799

### USA, Latin America and Caribbean

ENERPAC  
P.O. Box 3241  
6100 N. Baker Road  
Milwaukee, WI 53209 USA  
Tel: +1 262 781 6600  
Fax: +1 262 783 9562

**User inquiries:**  
+1 800 433 2766

**Inquiries/orders:**  
+1 800 558 0530

**Technical Inquiries:**  
techservices@enerpac.com

ENERPAC  
704 W. Simonds  
Dallas, TX 75159 USA  
Tel: +1 972 287 2390  
Fax: +1 972 287 4469

All Enerpac products are guaranteed against defects in workmanship and materials for as long as you own them.  
For your nearest authorized Enerpac Service Center, visit us at [www.enerpac.com](http://www.enerpac.com)